

TEST REPORT

No. : XMIN2006005122CM

Date : Jul 01, 2020

Page: 1 of 5

CUSTOMER NAME:

ADDRESS:

Sample Name : SPC FLOOR

Product Specification : SPC floor 5.5mm thickness (included IXPE 1.5mm)

Manufacturer :

Material and Mark : PVC+Calcium carbonat + Additives

Above information and sample(s) was/were submitted and confirmed by the client. SGS, however, assumes no responsibility to verify the accuracy, adequacy and completeness of the sample information provided by client.

Date of Receipt : Jun 15, 2020

Testing Start Date : Jun 15, 2020

Testing End Date : Jun 29, 2020

Test result(s) : For further details, please refer to the following page(s)
(Unless otherwise stated the results shown in this test report refer only to the sample(s) tested)

Signed for
SGS-CSTC Standards Technical
Services Co., Ltd Xiamen Branch
Testing Center

Bryan Hong
Authorized signatory

TEST REPORT

No. : XMIN2006005122CM

Date : Jul 01, 2020

Page: 2 of 5

Summary of Results:

No.	Test Item	Test Method	Result
1	Determination of Impact Sound Insulation Class	ASTM E492-09(2016) ^{ε1} ASTM E989-18	IIC = 69

Original Sample Photo:

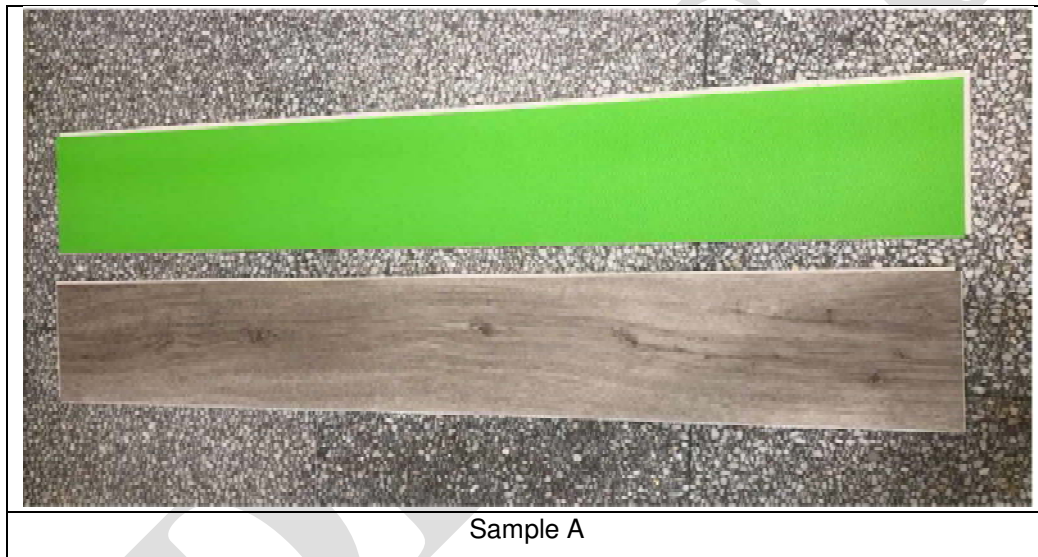

TEST REPORT

No. : XMIN2006005122CM

Date : Jul 01, 2020

Page: 3 of 5

Test Condition:

- Sample Description : Flooring (see the photo)
Total Thickness: 5.5(4+1.5) mm, surface density: about 8.2kg/m², at the bottom of the sample with 1.5mm cushion pad.
- Test conducted : ASTM E492-09(2016)^{ε1}, ASTM E989-18
- Project description : No decoration of sample surface, sample installation was assembled directly.
The test specimen was covered on a 150mm concrete floor with a drop ceiling, testing area 11.3m², the drop ceiling construction showed in the following
Drop ceiling: 288mm cavity filled with 50mm glass wool, 12mm gypsum board.
- Test Equipment : RTA840 system
- Test Environment : Source room volume 125m³, receiving room volume 100m³, air temperature 22.2°C, air humidity 60.2%

TEST REPORT

No. : XMIN2006005122CM

Date : Jul 01, 2020

Page: 4 of 5

Frequency spectrum for IIC

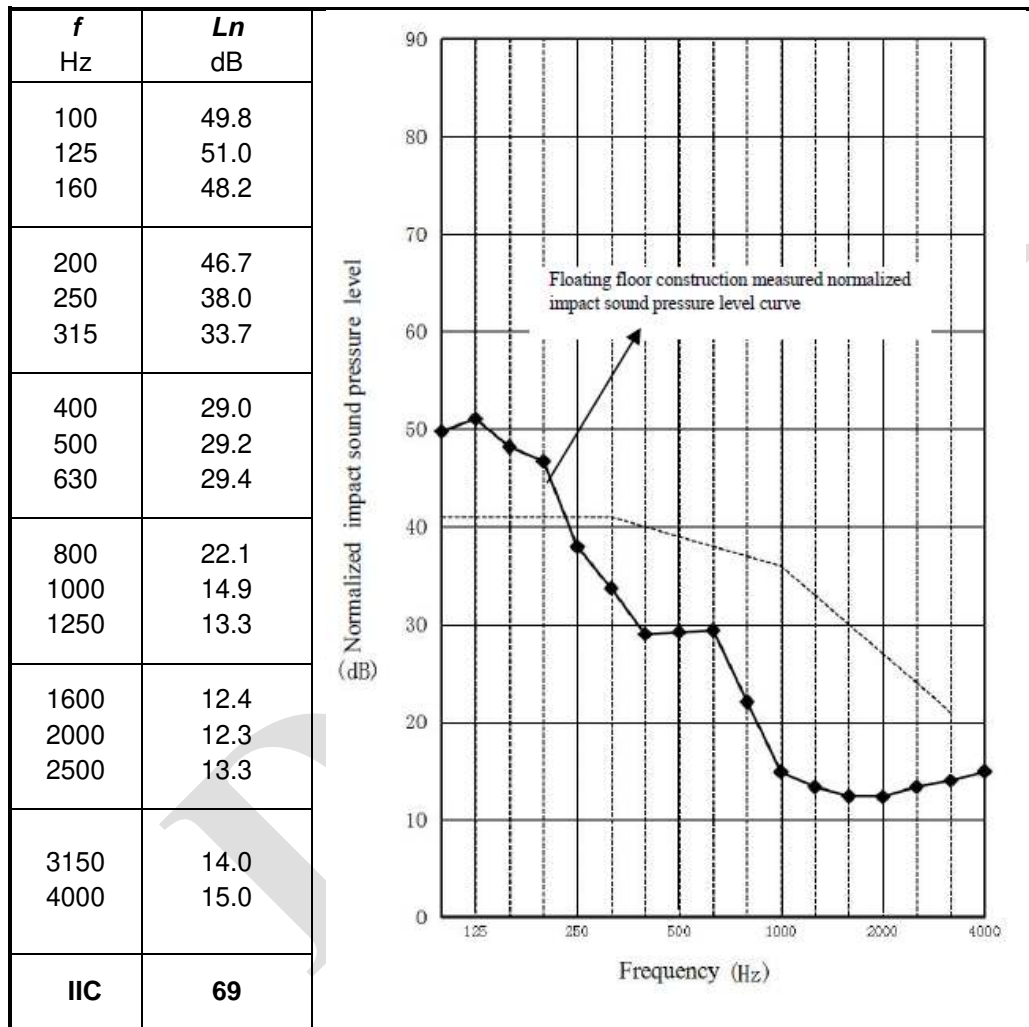

Remark: L_n as the weighted normalized impact sound pressure level

TEST REPORT

No. : XMIN2006005122CM

Date : Jul 01, 2020

Page: 5 of 5

The constructional drawing of the floor/ceiling assembly system

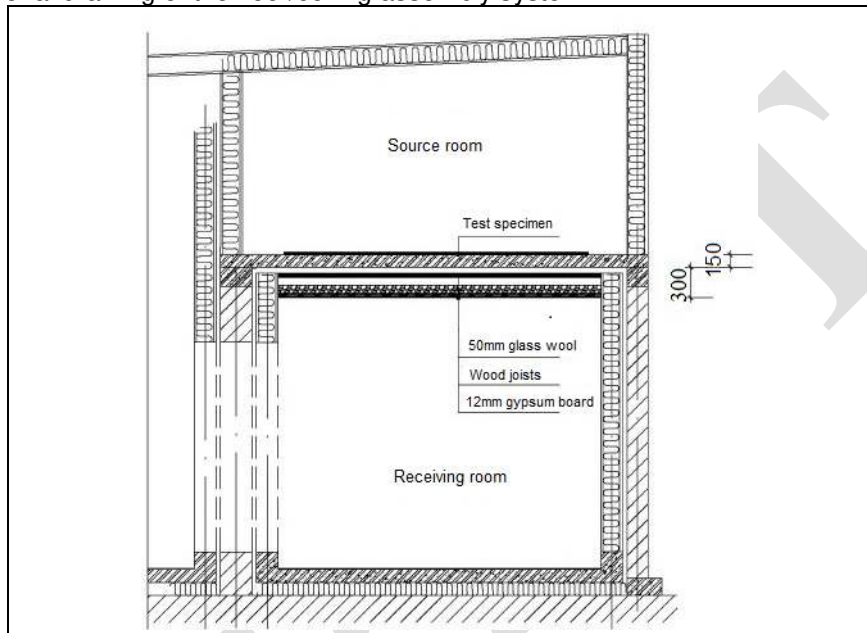

Schematic diagram:

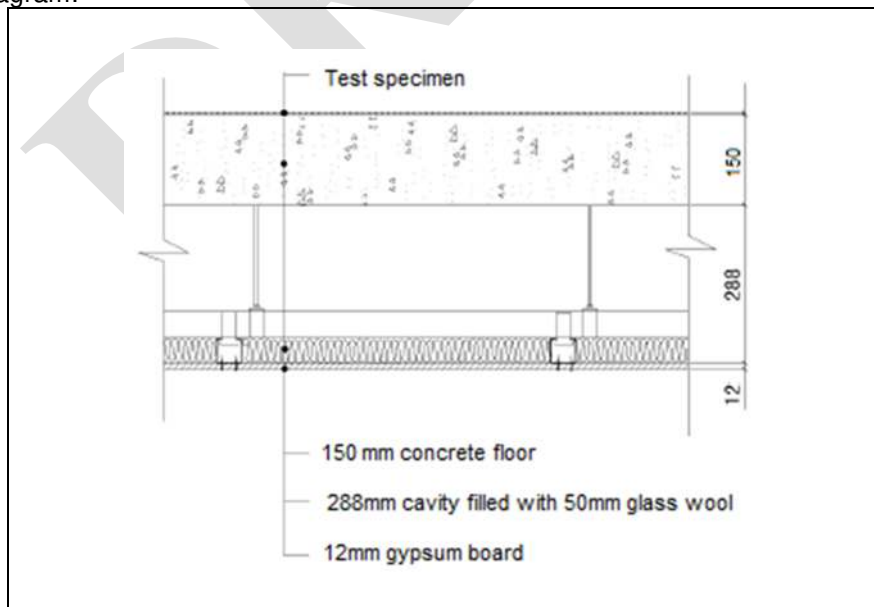

Note: The above test was carried out by Center for Building Environment Test, Tsinghua University.

***** End of report*****